

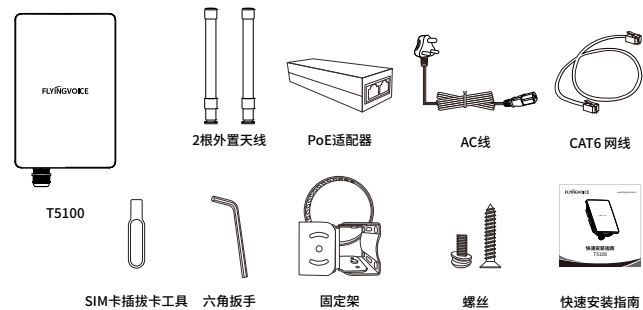

快速安装指南
T5100

1 包装清单

请检查您购买的产品是否包含以下组成件,若缺少请与您的经销商联系。



2 产品结构

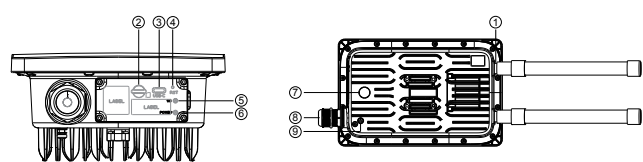

序号	名称	说明
①	外置天线接口	支持外接2根自带的5G全向天线
②	SIM卡槽	支持插入Nano-SIM卡供网
③	USB 3.0 Type-C	用于调试或紧急升级
④	RST按钮	重启设备:短按1-5秒; 恢复出厂设置:长按5秒以上
⑤	5G指示灯	详见下表
⑥	电源指示灯	详见下表
⑦	气压阀	内部设备正常运行时会发热,用于平衡内部气压
⑧	网线防水接口	整机IP67级别防水,可从此接口接入PoE适配器
⑨	GND接口	连地防雷击,保护设备在户外正常运行

5G指示灯	状态	描述
	绿色常亮	信号强
	蓝色常亮	信号中等
	红色常亮	信号弱
	蓝色快闪(10Hz) 3秒	切换网络模式3G<->4G<->5G
	红色慢闪(1Hz)	未联网
	熄灭	没有插入SIM卡或无法正确识别SIM卡

电源指示灯	状态	描述
	红色常亮	上电开机中/重启过程中/设备故障或异常
	绿色常亮	上电开机完成
	红色快闪(10Hz)	恢复出厂过程中/升级过程中
	熄灭	无电源

3 设备安装

设备支持以下两种安装方式,请使用飞音标配的配件进行组装。

柱式安装

- 将⑤围绕安装杆并穿过④的孔位, 拧紧⑤再将其螺丝拧紧以固定;
- 将②用包装附带的螺丝安装至外壳①的背部;
- 将③安装到④上,并用螺丝固定;
- 将①②用螺丝整体固定于③上。

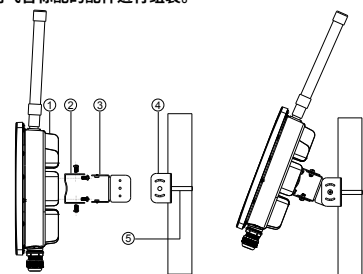

墙面安装

- 将④用包装附带的螺丝固定于墙面;
- 将②用包装附带的螺丝安装至外壳①的背部;
- 将③安装到④上,并用螺丝固定;
- 将①②用标配的螺丝整体固定于③上。

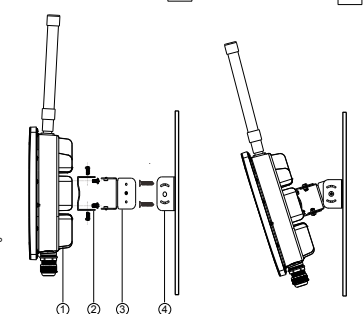

4 设备配置

将设备正确固定后,进行上电配置。

- 使用附带的2根外置天线,安装在设备顶部的接口处,扭紧即可。
- 从运营商处获取标准的 Nano-SIM 卡,打开设备底部的卡槽盖,插入SIM卡后再盖好。

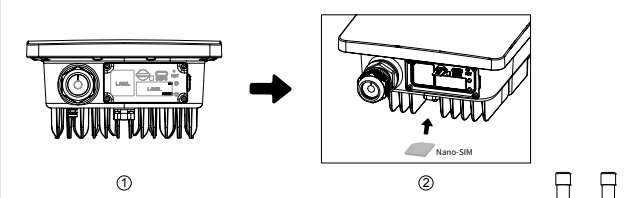

- 将标配的AC线与PoE适配器一端连接,再将CAT6网线一端接入PoE适配器的PWR网口,另一端接入设备底部的LAN口,最后将AC线插入电源,设备上电启动,并自动接入互联网。

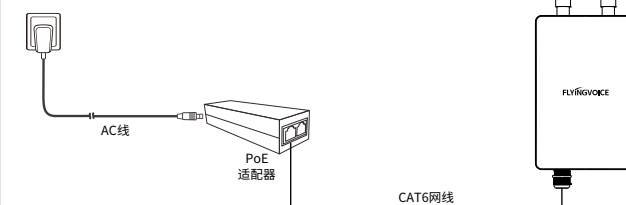

第四步 您可通过连接PC,进行Web功能配置。使用另一根RJ45网线,一端接入PoE适配器的PoE口,一端接入PC,并在PC上通过浏览器访问设备管理地址(默认:192.168.225.1)进入登录页面。初始管理员账号和密码为:admin/SN后六位。登录成功后,自动进入后台配置页面,即可进行相应配置。



飞音时代产品保修条例

尊敬的客户:

感谢您选购深圳飞音时代网络通讯技术有限公司的产品。自您购买产品之日起,凡按照使用说明书安装使用,一年内本公司免费维修,一年后维修只收取维修工本费。非本公司产品质量原因引起的维修,如使用不当,保管不妥,擅自拆机等原因造成的损坏,将收取维修工本费。

保修卡 Warranty card

产品型号/Model	客户名称/Customer Name	标签/Tag
		购买日期/Data of Purchase
	客户地址/Customer Address	
	联系人/Contact Person	电话/TeL
	经销单位/Distribution Units	
	联系人/Contact Person	电话/TeL
	销售日期/Data of Sale	

注:申请产品维修时,请把此保修卡和所购产品一起妥善送(寄)回售后服务部。

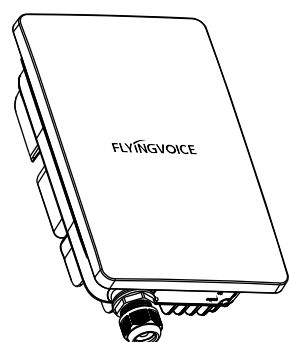

Quick Installation Guide
T5100

1 Packing List

The following items are included in your package. Please contact your service provider, if you find anything missing.

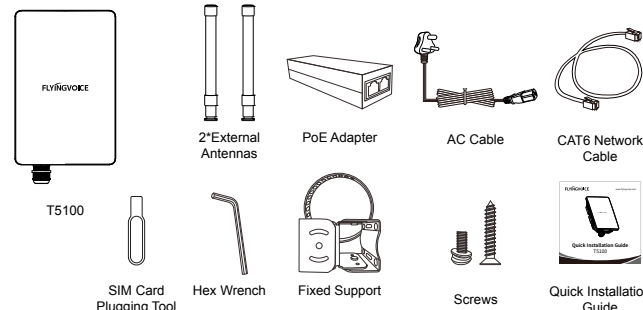

2 Physical Specification

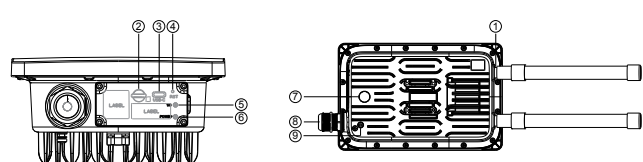

Number	Name	Description
①	External Antenna Interface	Support external connection of two 5G omni-directional antennas
②	SIM Card Slot	Insert a 5G SIM card to enable 5G network
③	USB 3.0 Type-C	Configuration or emergency upgrade
④	Reset Button	Reboot: Press for 1~5s; Reset: Press for more than 5s
⑤	5G Indicator	See the table below for details
⑥	Power Indicator	See the table below for details
⑦	Pneumatic Valve	Balance the internal air pressure due to inner heat
⑧	Network Cable Port	Used for PoE adapter, support IP67 waterproof
⑨	GND Port	Connect to earth to prevent lightning strikes

5G Indicator	Status	Description
	Steady Green	Strong signal
	Steady Blue	Moderate signal
	Steady Red	Weak signal
	Fast Flashing Blue (10Hz) 3s	Switching Network Mode 3G<->4G<->5G
	Slow Flashing Red (1Hz)	Internet Disconnected
	Light Off	No SIM card or the SIM card can't be recognized correctly

Power Indicator	Status	Description
	Steady Red	Booting/Rebooting/Device Disorder
	Steady Green	Successful Boot Up
	Fast Flashing Red (10Hz)	Resetting/Upgrading
	Light Off	No power supply

3 Device Installation

The device supports the following two installation methods, please use Flyingvoice's standard accessories for assembly.

Post-Fixed

- Put ⑤ around the mounting post and through the hole of ④, tighten ⑤ and then tighten the screws to fix it;
- Attach ② to the back of ① with the screws included in the package;
- Attach ③ to ④ and fix them with the screws;
- Attach ① and ② with the screws to ③ as a whole.

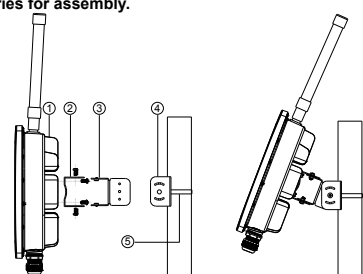

Wall-mounted

- Attach ④ to the wall with the screws included in the package;
- Attach ② to the back of the housing ① with the screws included in the package;
- Attach ③ to ④ and fasten it with the screws;
- Attach ① ② to ③ in its entirety with the screws supplied in the package.

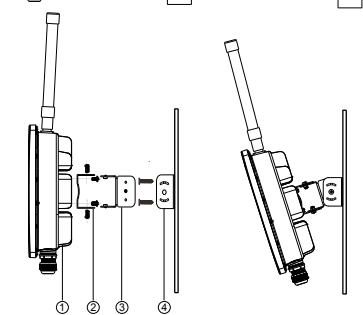

4 Device Configuration

After fixing the device correctly, proceed to the power-up configuration.

- Use the included 2 external antennas, install them at the interface on the top of the device, and tighten them.
- Obtain a standard Nano-SIM card from your carrier, open the card slot cover on the bottom of the device, insert the SIM card and then cover it.

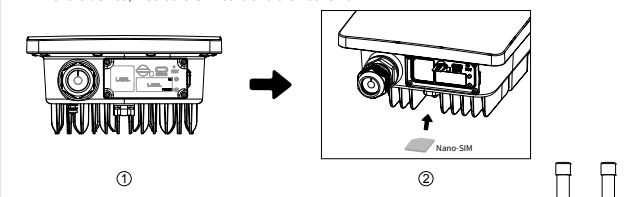

- Connect the standard AC cable to one end of the PoE adapter, then connect one end of the CAT6 cable to the PWR port of the PoE adapter, and the other end to the LAN port on the bottom of the device, and finally plug the AC cable into the power supply, the device will power on and start up, and automatically access the Internet.

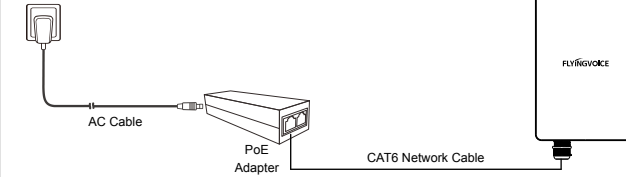

4. You can configure functions through the website by connecting the PC. Use another RJ45 cable to connect the PoE port of the PoE adapter to the PC, and the PC accesses the device management address (default: 192.168.225.1) through a browser to enter the login page.

The initial administrator account/password: admin/the last 6 digits of the serial number. After successful login, you can automatically enter the background configuration page to perform the corresponding configuration.

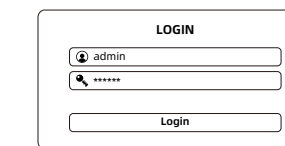

Flyingvoice Product Warranty Regulations

Dear Customer:

Thank you for purchasing the products of Shenzhen Flyingvoice Network Technology Co., Ltd.

Since the date of purchase, where the installation and use in accordance with the quick installation guide, our company will provide free maintenance within one year, after one year maintenance only charge the maintenance fee. Maintenance for non-product quality issues, such as improper use, improper storage, unauthorized disassembly and other causes for damage, will be charged for maintenance fee.

Note: When applying for product maintenance, please send the Warranty Card in this quick installation guide (in another page) and the purchased product back to the customer service department properly for maintenance.